

Wendland Lantern Surveying Leaflet

- When specifying the dimensions of your Wendland lantern, please provide the external dimensions of your upstand/ kerb.
- Upstand / kerb to be a minimum of 150mm tall. The Lantern eaves beam is 70mm wide the upstand width needs to accommodate this.
- Ensure your upstand / kerb is built square by measuring the diagonals / cross tie dimensions from corner to corner
- The customer must ensure that the kerb and surrounding roof can adequately resist the horizontal spread of the lantern.

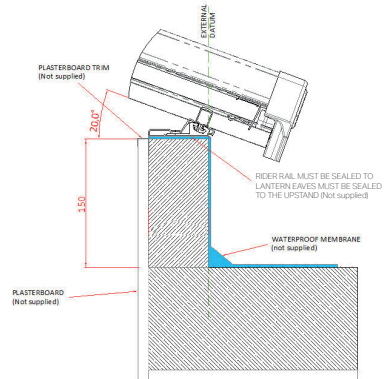

Measuring the height of the lantern

To measure the height of the Wendland lantern, the calculation is:

- Half width x Tan (20°) + 11mm rider rail + 91mm (ridge body) = Overall height

Example below based on 1000mm wide lantern.

- Half width (500) x Tan (20°) = 182mm
- + 11mm rider rail = 193mm
- + 91mm (ridge body) = 284mm overall height

